

THE EASTLAKE

11446 S. BINGHAM RIM ROAD



Exterior C

2,901 sq. ft.

3 Bedrooms

2 Full Baths

1 Half Bath

2 Car Garage

Perez Family



Best Homebuying Experience Ever

We have had several homes built in the past by several homebuilders. Our experience with David Weekley was the best we have ever had. The attention to detail and the customer service were exceptional. Both our sales person and Project Manager kept us well informed and treated us like family. Thanks David Weekley

Chelsea



Incredible Experience, Incredible Home!

We trusted the team from Day 1 and couldn't have asked for a better experience. The attention to detail was fantastic, and we felt as if the DWH team had a personal interest in the success of our home. The process was well defined and every team member set very clear expectations. We love every inch of our home, and we'd definitely recommend DWH!

David Weekley
Homes

THE EASTLAKE

11446 S. BINGHAM RIM ROAD

2,901 sq. ft. • 3 Bedrooms • 2 Full Baths • 1 Half Bath • 2 Car Garage



53200330 SLC

8/14/2024

THE EASTLAKE

11446 S. BINGHAM RIM ROAD



THE EASTLAKE

11446 S. BINGHAM RIM ROAD

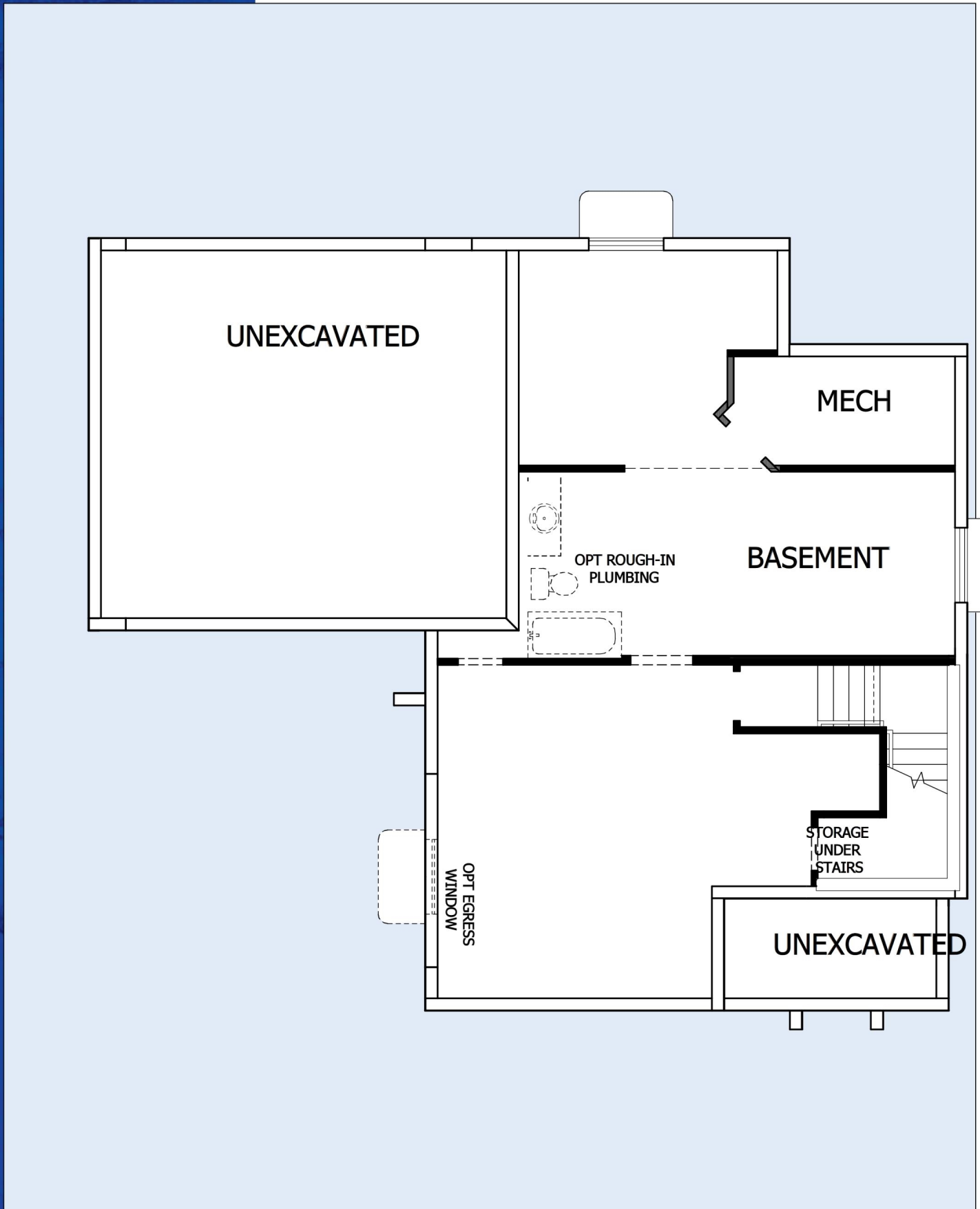

See a David Weekley Homes Sales Consultant for details. Prices, plans, dimensions, features, specifications, material and availability of homes or communities are subject to change without notice or obligation. Illustrations are artist's depictions only and may differ from completed improvements. Copyright © 2024 David Weekley Homes - All Rights Reserved. South Jordan, UT

[DavidWeekleyHomes.com](https://www.DavidWeekleyHomes.com)

